

# Kingpinless CASTORS



Richmond's kingpinless castors give you the best combination of brute strength with easy maneuverability and rollability. With a choice of Solid Black Nylon or Poly-Tyred Cast Iron Centred wheels with swivel, rigid and brake options these are also one of our most versatile, high-capacity castor series available.

## Advantages of a kingpinless castor

A kingpinless castor is made up of fewer components which therefore requires less maintenance and is suitable for high loads.

The castor's load is also spread over a larger area and swivels more freely.



S6152



S6154



S6154B

### Black Nylon Wheel Castors



Diameter (mm)	Width (mm)	Wheel Type	Wheel Code	Bearing Type	Load Capacity (kg)	Height (mm)	Rigid Code	Swivel Code
150	75	Solid Nylon	NY617	Ball	1800/1500	190	R6153	S6152

### Polyurethane Tyred Cast Iron Centred Castors



Diameter (mm)	Width (mm)	Wheel Type	Wheel Code	Bearing Type	Load Capacity (kg)	Height (mm)	Rigid Code	Swivel Code
150	75	Poly Ci	PU619	Ball	1800/1500	190	R6155	S6154

### Baseplate dimensions & drilling patterns for Kingpinless Castors

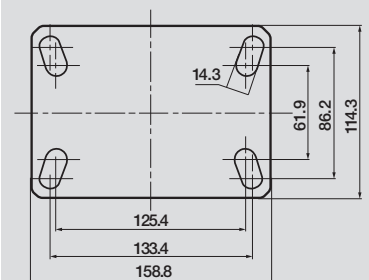

### Brake Options

B = Wheel Brake Only

To order castors with a Brake add B to end of swivel code e.g. S6154B.