

CONTAINER LOCKING CASTOR ASSEMBLY INSTRUCTIONS

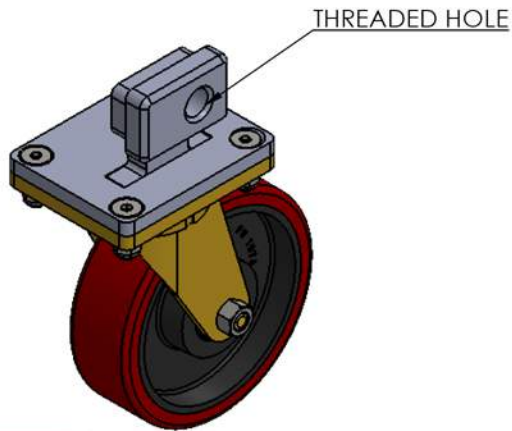

FRONT RIGHT / REAR LEFT CONTAINER CASTOR
NOTE THE THREADED HOLE POSITION

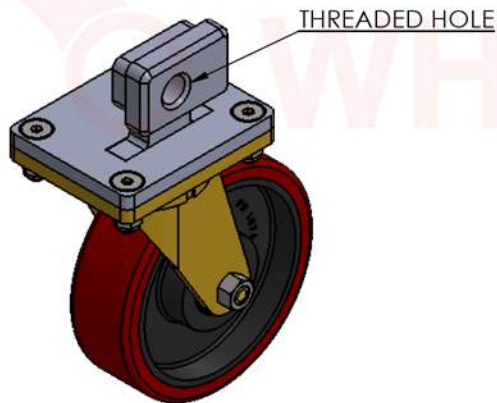

FRONT LEFT / REAR RIGHT CONTAINER CASTOR
NOTE THE THREADED HOLE POSITION

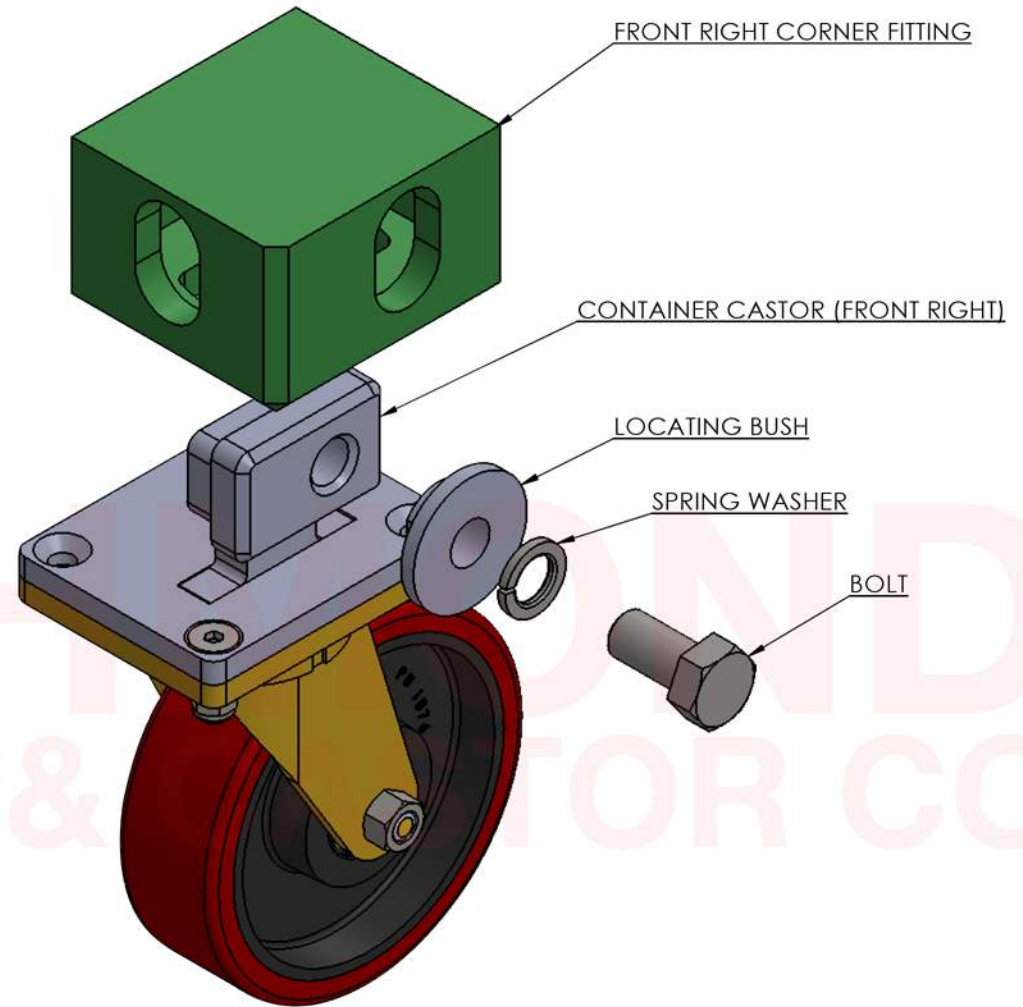

PROPRIETARY AND CONFIDENTIAL
THE INFORMATION CONTAINED IN THIS DRAWING IS THE SOLE PROPERTY OF Richmond Wheel & Castor Co. ANY REPRODUCTION IN PART OR AS A WHOLE WITHOUT THE WRITTEN PERMISSION OF Richmond Wheel & Castor Co. IS PROHIBITED.

	NAME	SIGNATURE	DATE
DRAWN	TOM	TM	26/08/2013
CHK'D	SY	SY	26/08/2013
APPV'D	RAY	RW	26/08/2013
MFG	SY	SY	26/08/2013
Q.A	BARRY	BN	26/08/2013

UNLESS OTHERWISE SPECIFIED:
DIMENSIONS ARE IN MILLIMETERS
TOLERANCES TO 0.25MM

DEBUR AND
BREAK SHARP
EDGES



DO NOT SCALE DRAWING	REVISION	FINISH:
TITLE: RICHMOND WHEEL & CASTOR CO.		
DWG NO 195CONT-LOCKIT ASSEM PROCEDURE		A3

WEIGHT:

SHEET 1 OF 2

195CONT-LOCKITR ASSEMBLY INSTRUCTIONS

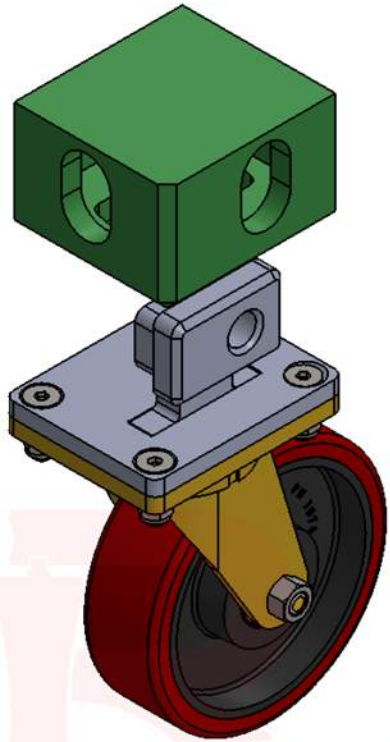

STEP 1: POSITION CASTOR UNDER CORNER FITTING AND INSERT CONTAINER CASTOR

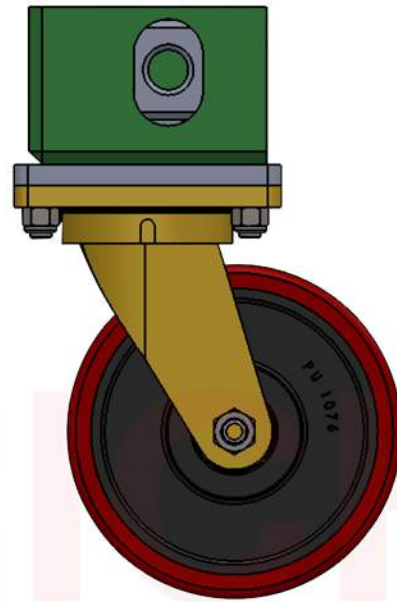

STEP 2: ALIGN THREADED HOLE WITH SLOT IN CORNER FITTING

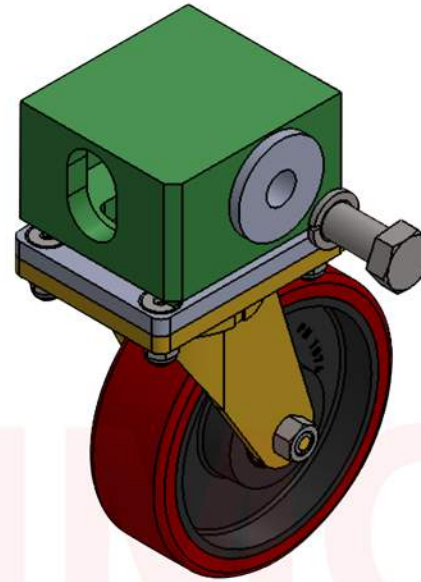

STEP 3: INSERT BUSH

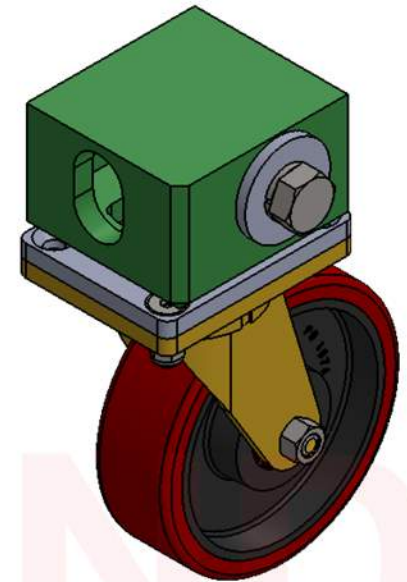

STEP 4: ASSEMBLY SPRING WASHER AND BOLT AND TIGHTEN UNTILL FIRM

PROPRIETARY AND CONFIDENTIAL
 THE INFORMATION CONTAINED IN THIS DRAWING IS THE SOLE PROPERTY OF Richmond Wheel & Castor Co. ANY REPRODUCTION IN PART OR AS A WHOLE WITHOUT THE WRITTEN PERMISSION OF Richmond Wheel & Castor Co. IS PROHIBITED.

	NAME	SIGNATURE	DATE
DRAWN	TOM	TM	26/08/2013
CHK'D	SY	SY	26/08/2013
APP'V'D	RAY	RW	26/08/2013
MFG	SY	SY	26/08/2013
Q.A	BARRY	BN	26/08/2013

UNLESS OTHERWISE SPECIFIED:
 DIMENSIONS ARE IN MILLIMETERS
 TOLERANCES TO 0.25MM

DEBUR AND
 BREAK SHARP
 EDGES



DO NOT SCALE DRAWING	REVISION	FINISH:
TITLE: RICHMOND WHEEL & CASTOR CO.		
DWG NO 195CONT-LOCKITR ASSEM PROCEDURE		A3